

MIMO 2xLTE / 2xWLAN / 1xGPS-GNSS-GALILEO

T-AT8810.01

SPECIFICATIONS

Material	Aluminium alloy EN AW-6082
Base	ABS Gray
Radome	Stainless steel
Screws and nuts	Stainless steel
Dimensions (mm)	162x142x45
Temperature (°C)	-40° - +80°
Mounting	Vertical or horizontal
Fixing	According to FEDERTRASPORTI 00104/5

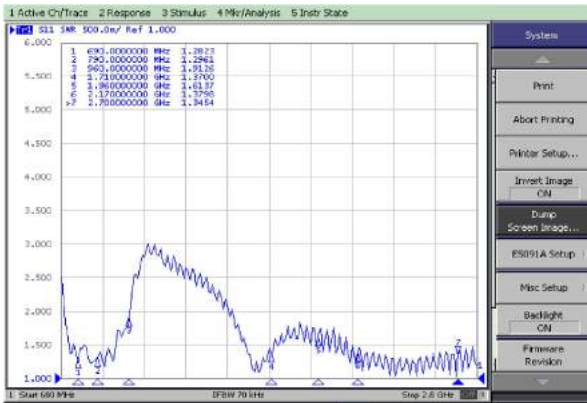

W.S.W.R. Measured with 3000mm cable RG316

TECHNICAL DATA 2xLTE

Antenna type	Low profile panel antenna
Frequency range	AMPS/GSM 850 : 824 - 894MHz GSM 900 : 880 - 960MHz GSM 1800 : 1710 -1880 MHz GSM 1900: 1850 - 1990 MHz UMTS : 1920 - 2170 MHz LTE700 : 746 - 793 MHz LTE2700 : 2500 - 2690 MHz
Gain (dBi)	2.5 ± 1 698-960 Mhz 3.5 ± 1 1710-2170 Mhz 2±1 2300-2690 Mhz
Isolation (dB)	690-960 - >10 1710-2690 - >15
Impedance (Ohms)	50
Max power (W)	20
V.S.W.R.	Less than 2.2
Polarization	Vertical
Cable	RG174 mm.500
Connector	SMA R.P. Male

TECHNICAL DATA 2xWLAN

Frequency range	2400-2485 MHz 5250-5850 MHz
Impedance (Ohms):	50
V.S.W.R.	Less than 2
Polarization:	Vertical
Emission:	Omnidirectional
Gain (dBi):	1.5 ± 0.5 dBi 2400 - 2485 Mhz 1.5 ± 0.5 dBi 5250 - 5850 Mhz
Cable	RG316 mm.500
Connector	SMA R.P. Male

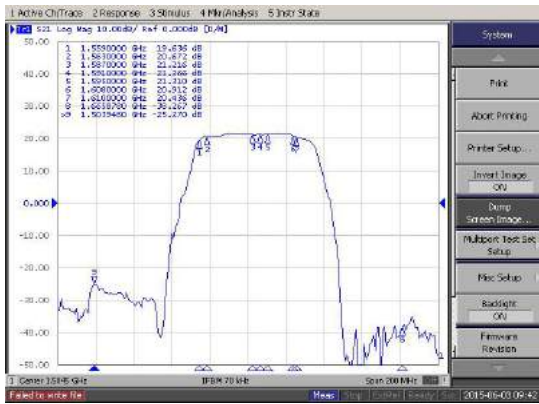

TECHNICAL DATA 1xGPS/GNSS/GALILEO

Antenna type	Active Planar Patch Antenna
Center frequency	1580 MHz
Bandwidth	± 28MHz
V.S.W.R	Less than 2.0
Impedance (Ohms)	50
Polarization	RHCP
Supply voltage	2.7 ÷ 5.1 V
Current absorption	10 ± 1 mA at 2.7 V. 16 ± 1 mA at 5.0 V.
Gain amplifier	18 ± 1 dB at 2.7 V. 22 ± 1 dB at 5.0 V.
Gain patch antenna	2 dB
Noise figure	1.7 ÷ 2.1 dB
Temperature (°C)	-30° - + 80°
Cable	RG174 mm.500
Connector	SMA R.P. Male

Certificated E24 10R-041857

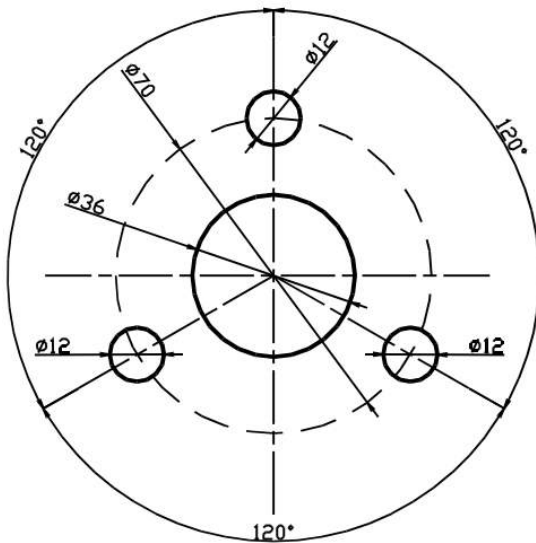

in conformity with
FEDERTRASPORTI 00104/5

Atel-Antennas S.r.l.

Viale Caduti sul Lavoro, 21/A - 15061 Arquata Scrivia (AL) - Italy

Tel. +39 0143 635496 - Fax +39 0143 666423 - Website: www.atel-antennas.eu - Mail: commerciale@atel-antennas.eu - P. IVA 02442250060

890MHz

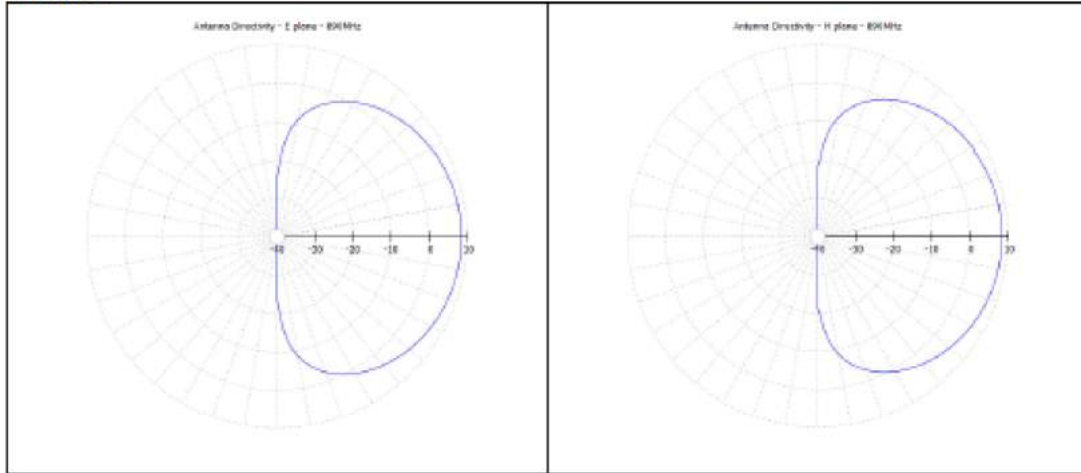

1940MHz

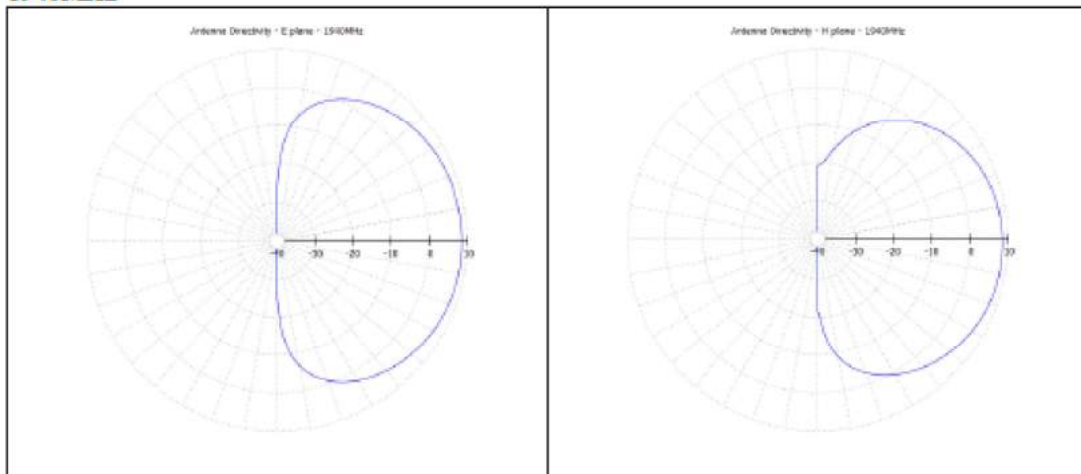

2590MHz

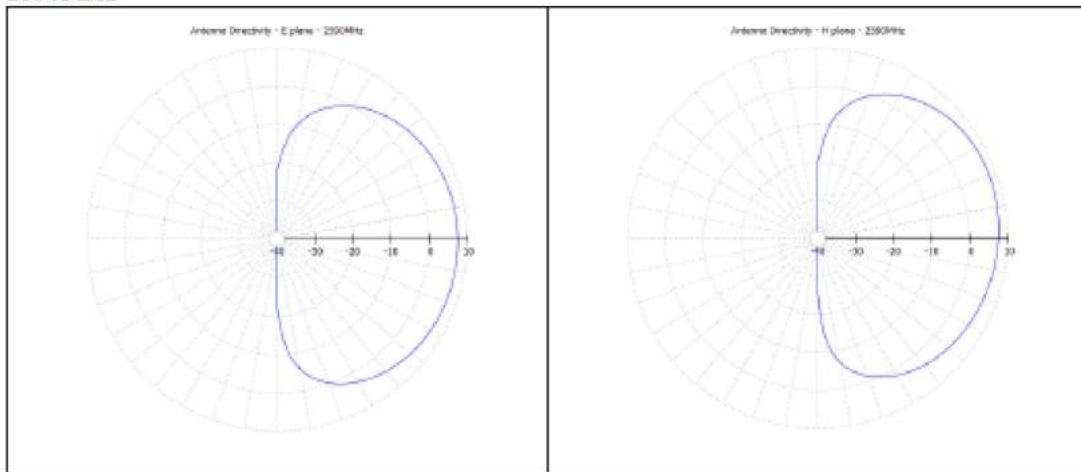

2450MHz

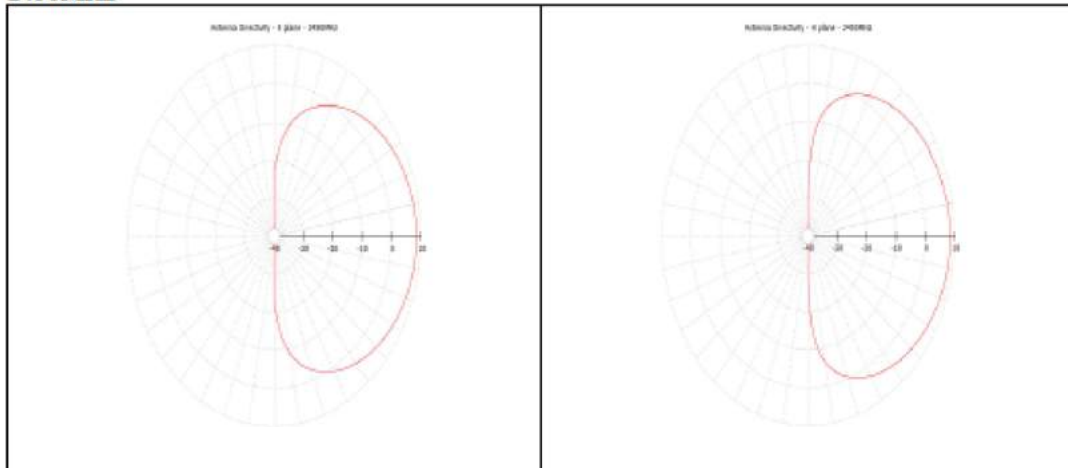

5150MHz

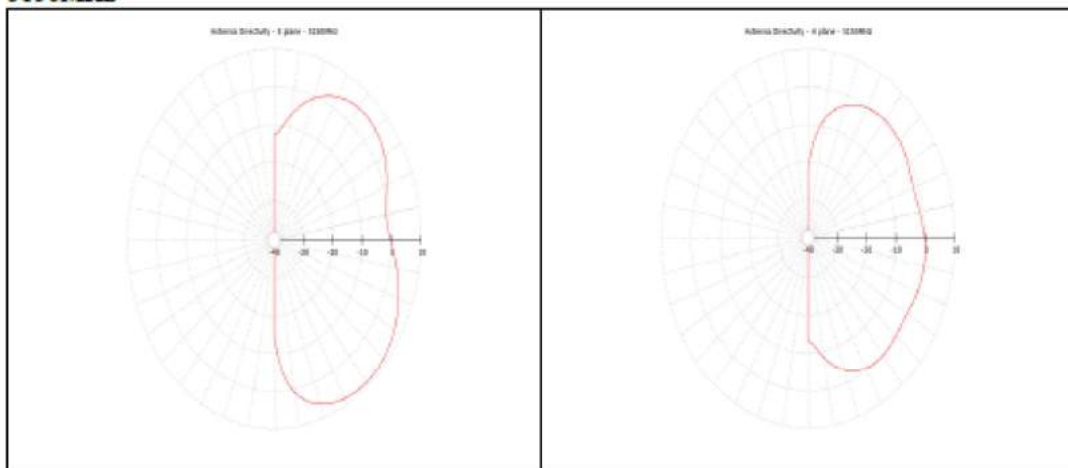

5850MHz

