

INSIDE GLASS TETRA ANTENNA 380-430 MHz T-AT260

SPECIFICATIONS

Base material	Nylon / FR4
Colour	Black
Base dimensions (mm)	260 x 10
Temperature (°C)	-30° - +80°

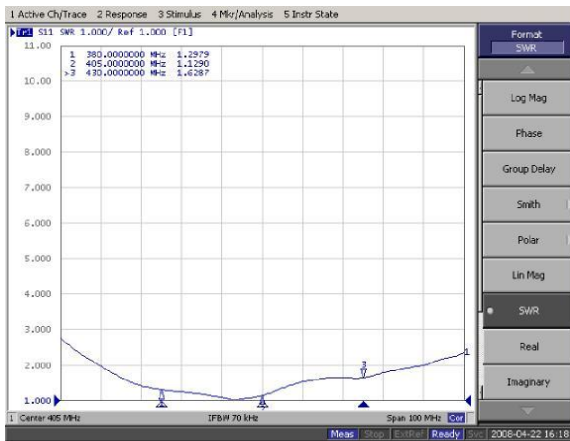
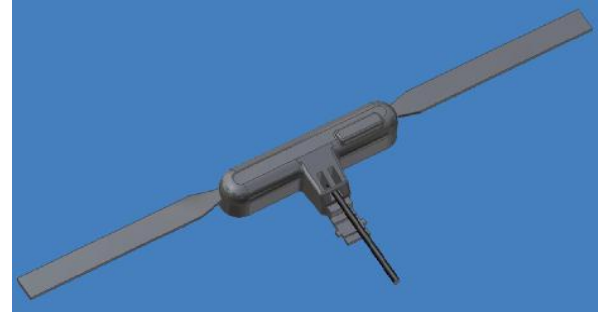

TECHNICAL DATA:

Antenna type	1/4 l Mobile Antenna
Frequency range	380 ÷ 430 MHz
Impedance (Ohms)	50
Max power (W)	20
V.S.W.R.	Less than 2.0
Gain (dBi)	2.14
Cable lenght	RG 174 mm.2500
Connector	FME F.

