

Type n° T-OC430/450.07

OMNIDIRECTIONAL ANTENNA UHF 430 ÷ 450 MHz

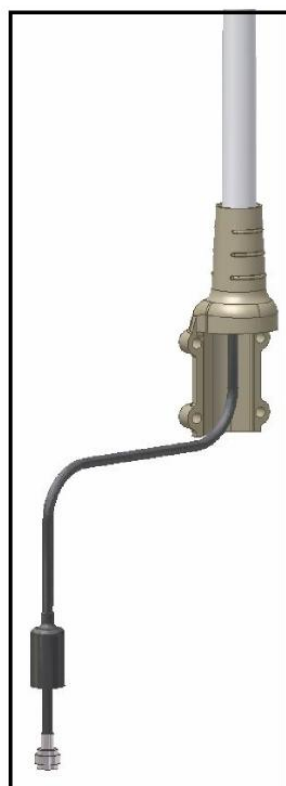
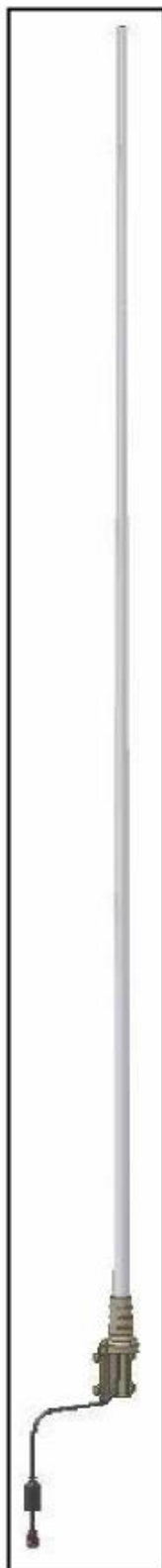

TECHNICAL DATA:

Impedance (Ohms):	50
Frequency range:	430 ÷ 450 MHz
V.S.W.R.:	less than 1.8
Beamwidth -3 dB:	19°
Polarization:	Vertical
Connector:	N-male
Cable lenght:	mm.1000 with fairlead
Mounting:	on masts from 33 to 60 mm diam.
Gain (dBi):	7
Max power (W):	100
Wind resistance:	160 Km/h
Temperature (°C):	-40° - +85°
Dimensions (mm):	2700÷2900
Net weight (g):	1800
Material	
Bracket:	Aluminium alloy EN AB-44100
Conical mast:	Fiberglass
Screws and nuts:	Stainless steel

V.S.W.R. CURVE

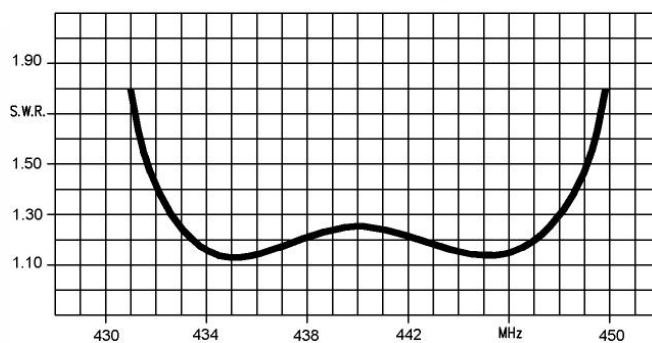

FREQUENCY: 440 MHz
DATE: 10-06-2010

FRONT TO SIDE RATIO:-46.7dB
ELEVATION:-1.5°

LEVEL 0 dB

LINEAR SCALE

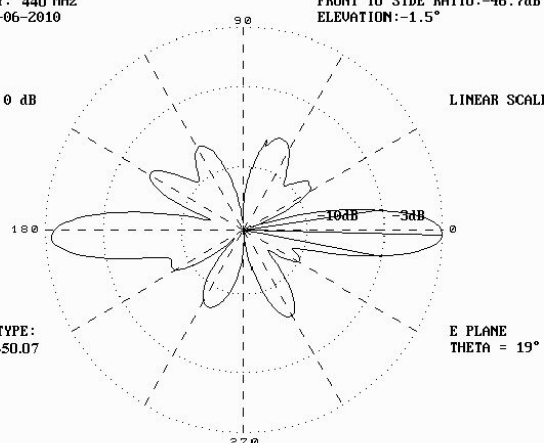

ANTENNA TYPE:
T-OC430/450.07

E PLANE
THETA = 19°

Atel-Antennas S.r.l.